

Copper Ridge

Conveniently located on the north side of Sanford, Copper Ridge features fifty-two approximately one acre homesites for the discerning individual. It is an easy commute to the Raleigh/Cary/Durham/Chapel Hill areas. Copper Ridge is 26 miles or 23 minutes to I-40, and a mere 15 minutes to the future I-540 — all on a four lane highway. From US # 1 exit number 76, Farrell Road east towards The Raleigh Executive Jetport @ Sanford - Lee County. You'll find Copper Ridge approximately 1/4 mile from US # 1 on the right.

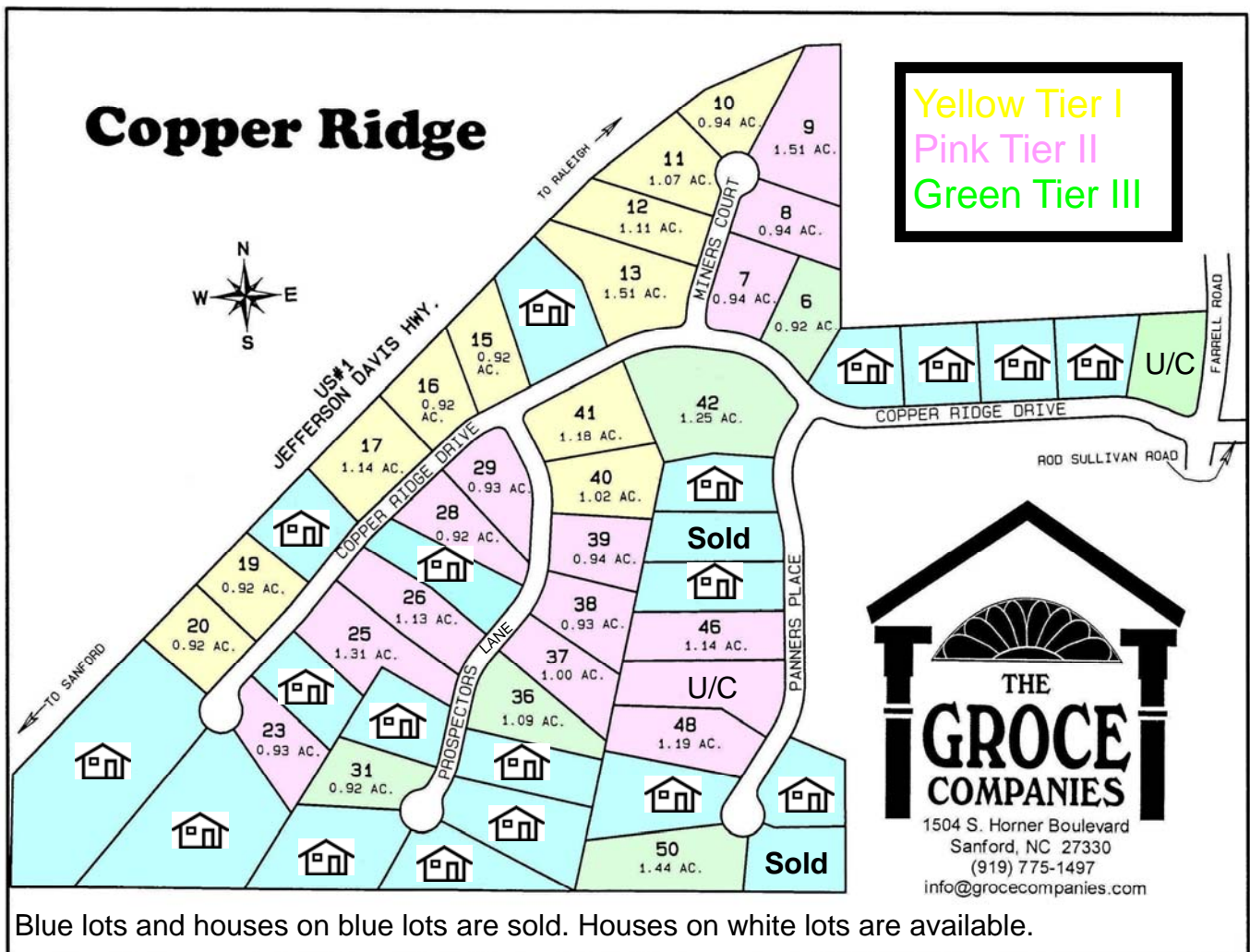

The Architecture Committee will maintain quality while allowing diversity of styles and materials.



**Visit models 1:00 to 5:00 pm
Saturdays and Sundays**

Sample Floor Plans Available. Call (919) 775-1497, (919) 770-4883 or (919) 770-2554.



www.grocecompanies.com